

1 SITE PHOTOMETRIC PLAN
1" = 30'-0"

STEEN
ENGINEERING, INC.
5430 Douglas Drive North
Crystal, MN 55429
Email: steen@steeneng.com
763-585-6757 fax

I HEREBY CERTIFY THAT THIS PLAN, SPECIFICATION, OR REPORT WAS PREPARED BY ME, OR UNDER MY DIRECT SUPERVISION, AND THAT I AM A LICENSED PROFESSIONAL ENGINEER UNDER THE LAWS OF THE STATE OF MINNESOTA

REG. NO. _____

PROJECT NO.: DUF201601
DATE: XX/XX/XX
DRAWN BY: DIL
CHECKED BY: SMY
REVISIONS:

SITE ELECTRICAL PLAN

BOTTINEAU RIDGE
PHASE II
MAPLE GROVE
MINNESOTA

Sheet Number
E1.1

Symbol	Label	Quantity	Manufacture	Catalog Number	Description	Lamp	Number Lamps	Filename	Lumens Per Lamp	Light Loss Factor	Wattage
	BB	2	Lithonia Lighting	CSXW LED 30C 700 40K T4M	CONTOUR SERIES LED WALL-MOUNT WITH 30 4000K LEDs OPERATED AT 7000mA AND PRECISION MOLDED ACRYLIC TYPE IV LENS	LED	1	CSXW_LED_30C_700_40K_T4M.ies	7924	1	69
	AA	3	CREE INC.	ARE-EDG-5Mxxx-06-E-ULxxx-700-40K-xxxx (BXALX506E-UD7)	Cree Edge Area, Type V, Medium, 60 LEDs, 700mA, 4000K	Sixty White LEDs, Vertical Base-Up Position	1	ARE-EDG-5Mxxx-06-E-ULxxx-700-40K.ies	12021	1	266

Description	Symbol	Avg	Max	Min	Max/Min	Avg/Min
drive-way	+	1.6 fc	6.2 fc	0.4 fc	15.5:1	4.5:1
north drive-way	+	3.0 fc	7.3 fc	0.1 fc	73.0:1	30.0:1
parking lot	+	1.4 fc	4.0 fc	0.3 fc	13.3:1	4.7:1
property line	+	0.0 fc	0.4 fc	0.0 fc	N/A	N/A
side walk	+	0.4 fc	3.5 fc	0.0 fc	N/A	N/A

No.	Label	MH	TH
1	AA	23.00	0.00
2	AA	23.00	0.00
3	AA	23.00	0.00
1	BB	12.00	0.00
2	BB	12.00	0.00

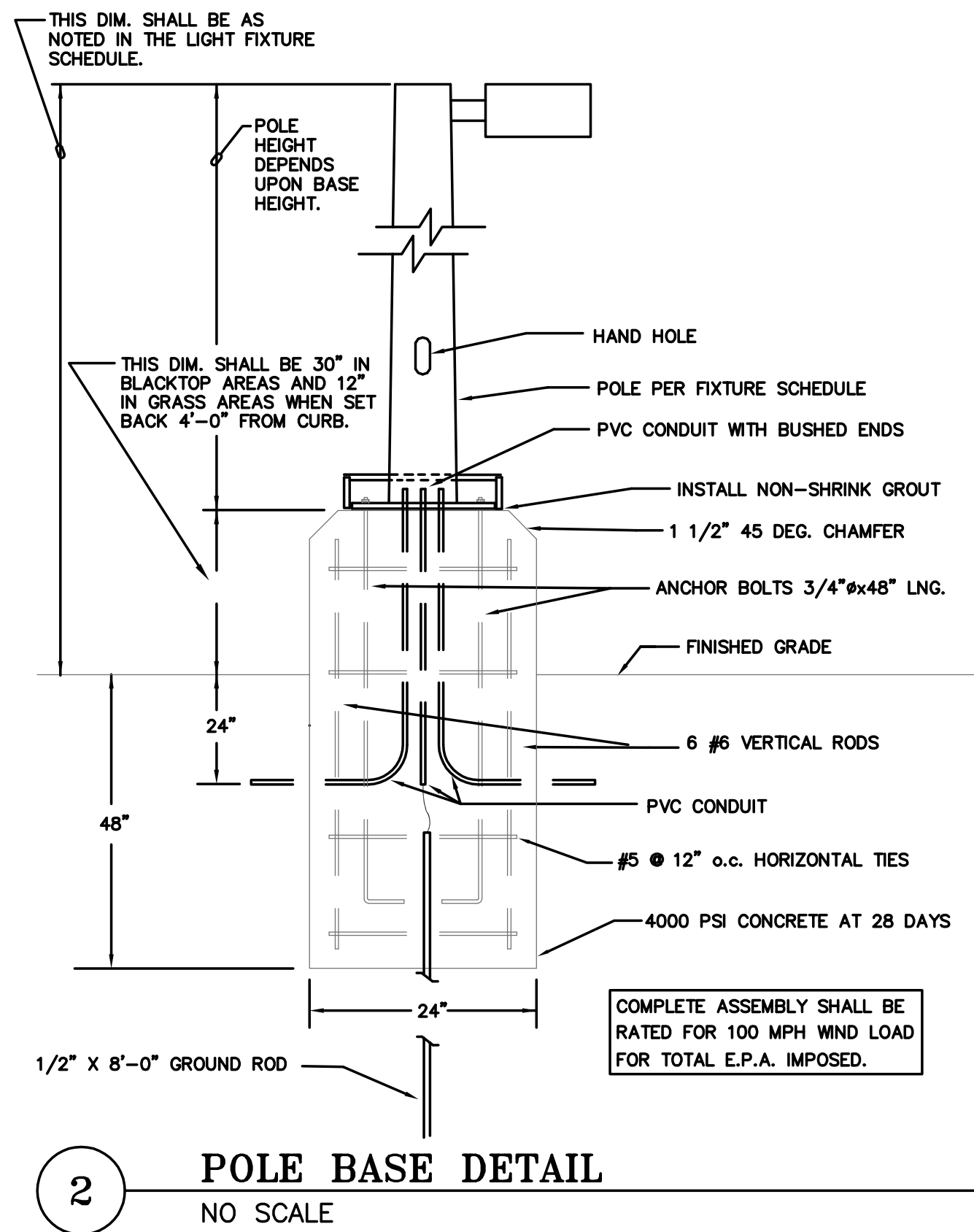

TYPE AA

Cree Edge™ Series LED High Output Area/Flood Luminaire featuring Cree TrueWhite™ Technology

Product Description
The Cree Edge™ High Output Area/Flood Luminaire is designed to deliver high lumen packages with precise optical control. The unit features a slim, low profile design that minimizes wind load and a rugged die cast aluminum adjustable arm that mounts to a horizontal or vertical 2" (51mm) IP, 2.375x2.50" (60.64mm) O.D. steel tenon. Tenon length must be a minimum of 3.75" (95mm). The direct mount bracket accessory allows for further mounting flexibility. Available with Cree TrueWhite™ Technology, the Cree Edge™ High Output helps to beautifully render true colors and deliver value beyond energy savings.
Applications: Auto dealerships, parking lots, campuses, facade lighting, high-mast and general site lighting applications

Performance Summary
Utilizes Cree TrueWhite™ Technology on 5000K luminaires
Patented NanoOptic™ Product Technology
Made in the U.S.A. of U.S. and imported parts
CRI: Minimum 70 CRI (4000K & 5700K); 90 CRI (5000K)
CCT: 4000K (+/- 300K), 5000K (+/- 300K), 5700K (+/- 500K) standard
Limited Warranty: 10 years on luminaire/10 years on Colorfast DeltaGuard® finish

Accessories

Field-Installed	Backlight Control Shields
120 LED 1A-880SPKXK12	XA-308-S-4 -Four pack for 120 LED -Unpainted stainless steel
240 LED 1A-880SPKXK24	XA-308-S-8 -Eight pack for 240 LED -Unpainted stainless steel

Ordering Information

Example: ARE-EDG-2M-HV-12-E-UL-DV-700

Product	Optic	Mounting	LED Count (x10)	Series	Voltage	Color Options	Drive Current	Options
ARE-EDG	2M Type II Medium 2M8 Type II Medium 3M Type III Medium	3M8 Type II w/LS 4M Type IV w/LS 4M8 Type IV Medium w/LS	12 24	E	UL 120-277V UL 180-480V	BL 7000K BK 1000 BR 1000 SI White	700mA 1000mA	DM 0-10V dimming - Control by others - Refer to dimming spec sheet for details - Can't exceed specified drive current - Refer to UL spec sheet for details - Refer to UL spec sheet for details - Not available with 18V voltage - Refer to UL spec sheet for details - Intended for daylight applications - 40° beam - Not available with 18V voltage or 240 LEDs with 1000mA drive current
FLD-BND	1S 1S Flood 2S 2S Flood	4S 4S Flood 8S 8S Flood	15 30	SN	Sign	NEMA 6		WEMA Photocell Recastable - 3 pin recastable per ANSI C136.18 - Intended for daylight applications with maximum 40° beam - Consult factory for vertical lens applications - Photocell and shatter cap by others - Refer to UL spec sheet for availability with 18V options - 40K 5000K Color Temperature - Maximum 70 CRI - Color temperature per luminaire - 50K 5000K Color Temperature - Maximum 90 CRI - Utilizes Cree TrueWhite™ Technology - Color temperature performance

NOTE: Price after may apply depending on configuration

UL US DGC ida CREE Rev. Date: V6.01/20/2016 CREE
US: www.cree.com/lighting T (800) 236-6800 F (262) 504-5415 Canada: www.cree.com/canada T (800) 473-1234 F (800) 890-7507

TYPE BB



CSXW LED LED Wall Luminaire



Catalog Number	
Notes	
Type	

Click the file key to zoom over the page to see all interactive elements.

Introduction

The Contour® Series luminaires offer traditional square dayforms with softened edges for a versatile look that complements many applications.

The CSXW LED combines the latest in LED technology with the familiar aesthetic of the Contour® Series for stylish, high-performance illumination that lasts. It is ideal for replacing 100-400W metal halide in wall-mounted applications with typical energy savings of 80% and expected service life of over 100,000 hours.

Specifications

Height: 7-1/8" (182.2 cm)
Width: 16-3/8" (416.4 mm)
Depth: 9-5/16" (238.6 mm)
Weight (max): 30 lbs (13.6 kg)

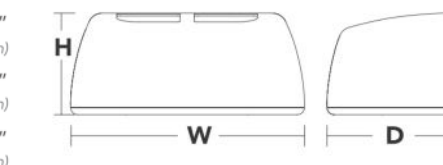

Ordering Information

EXAMPLE: CSXW LED 30C 700 40K T3M MVOLT DDBXD

Series	LEDs	Drive current	Color temperature	Distribution	Voltage	Mounting	Options	Finish
CSXW LED	30C	30 LEDs 700 700 mA 1000 1000 mA	40K 4000K 50K 5000K	T2M Type II, medium T3M Type II, medium T4M Type IV, medium TFTM Type forward throw, medium	MVOLT 120 V 208 V 240 V 277 V 347 V 480 V	Shipped included (blank) Surface mount	Shipped separately FE Photoelectric cell, button type 1" DMG 0-10V dimming driver (no controls) SF Single line (120, 277, 347V) DF Double line (208, 240, 480V)	Shipped separately VGF Vandal guard WG Wire guard

Mounting Detail

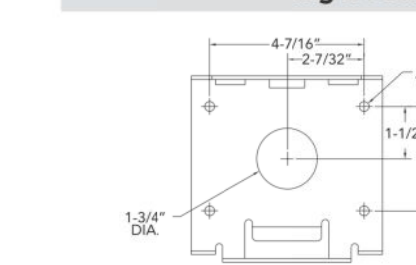

Accessories

CSXWHD DDBXD U Back box accessory (specify field)
CSXWGU U Wire guard accessory
CSXWGU V Vandal guard accessory

NOTES

1. Configured with 4000K (40K) provides the shortest lead times. Consult factory for 5000K (50K) lead times.
2. MVOLT driver operates on any line voltage from 120-277V (0/60 Hz). Specify 120, 208, 240 or 277 options only when ordering with factory DF, DF optional or photocell (FE) option.
3. Available with 700 mA options only (30C 700).
4. Also available as a separate accessory; see Accessories information at left.
5. Photocell (FE) requires 120, 208, 240, 277 or 347 voltage option.
6. Must be ordered with fixture; cannot be field installed.
7. Single line (SF) requires 120, 277 or 347 voltage option. Double line (DF) requires 208, 240 or 480 voltage option.



One Lithonia Way • Conyers, Georgia 30012 • Phone: 800.279.8041 • Fax: 770.918.1209 • www.lithonia.com
© 2012, 2014 Acuity Brands Lighting, Inc. All rights reserved.

CSXW-LED
Rev. 02/22/16

STEEN ENGINEERING, INC.
765-585-6757 fax
Email: steen@steeneng.com
5430 Douglas Drive North
Crystal, MN 55429

I HEREBY CERTIFY THAT THIS PLAN, SPECIFICATION, OR REPORT WAS PREPARED BY ME, OR UNDER MY DIRECT SUPERVISION, AND THAT I AM A LICENSED PROFESSIONAL ENGINEER UNDER THE LAWS OF THE STATE OF MINNESOTA.

PROJECT NO.: DUF021601
DATE: XX/XX/XX
DRAWN BY: DIL
CHECKED BY: SMY
REVISIONS:

SITE ELECTRICAL PLAN

BOTTINEAU RIDGE
PHASE II
MAPLE GROVE
MINNESOTA

Sheet Number
E1.2