

Legend

- 1- ELLIPTICAL
- 2- INCLINE TREADMILL
- 3- ROWER
- 4- STAIR CLIMBER
- 5- CYCLE BIKE

- 6-SMITH HALF RACK
- 7-DUMBBELLS 5-75
- 8-ADJ. BENCH
- 9- FUNCTIONAL TRAINER
- 10- BACK EXT BENCH
- 11- ACCESSORY STORAGE RACK- STAMINA PACKAGE

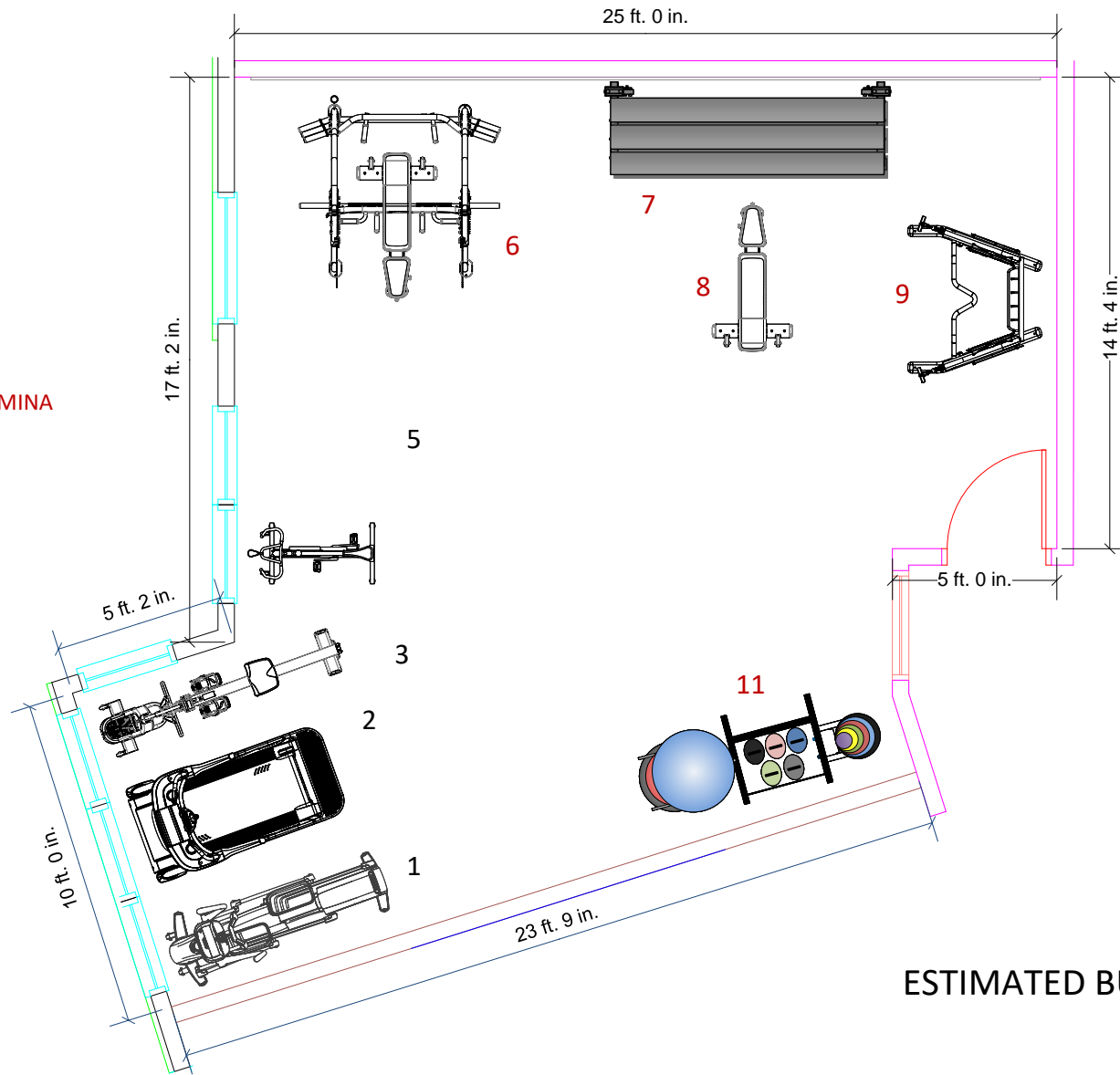

ESTIMATED BUDGET – \$31,000

- = *120VAC, 20AMP 60 Hz NEMA 5-20R
- = *220VAC, 20AMP 60 Hz NEMA 6-20R
- =110 VAC 50-60 Hz
- =Coaxial RF TV output, 75 ohm
- ▲ =RJ45 Ethernet Lan, CAT 6

EACH TREADMILL REQUIRES ITS OWN IND. BRANCH CIRCUIT W/ THE HOT, NEUTRAL, & GROUND WIRES RUNNING TO THE ELECTRICAL PANEL (Non GF)

FOR ADDITIONAL REQUIREMENTS PLEASE REFERENCE THE MANF. SPEC SHEET. CEILING HEIGHT OF TREADMILLS AND ELLIPTICALS IS 90"

THIS FLOOR PLAN IS PROVIDED FOR GENERAL VISUAL REFERENCE ONLY. P3 MAKES NO REPRESENTATION OR WARRANTY THAT THE FLOOR PLAN COMPLIES WITH ANY APPLICABLE LAW, RULE OR REGULATION OR ANY INDUSTRY OR SAFETY STANDARD OR REQUIREMENT. IT IS THE OWNERS SOLE RESPONSIBILITY TO INSURE THAT THE PLACEMENT OF EQUIPMENT, FURNITURE AND ASSOCIATED ITEMS IS SAFE AND COMPLIES WITH ALL APPLICABLE LAWS, RULES, REGULATIONS AND STANDARDS, AND P3 DISCLAIMS ALL RESPONSIBILITY WITH RESPECT THERETO.



FACILITY LAYOUT FOR:

Hugo West

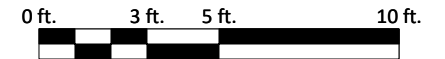

SALES CONTACT:

Chad Witt

DATE:

10/4/2024

SCALE:

3/16" = 1'

LAYOUT VERSION:

2